

1

2

3

4

5

A

A

LAYOUT

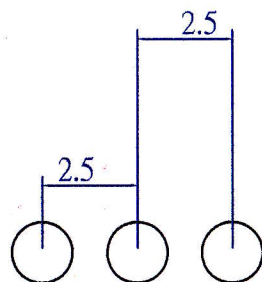
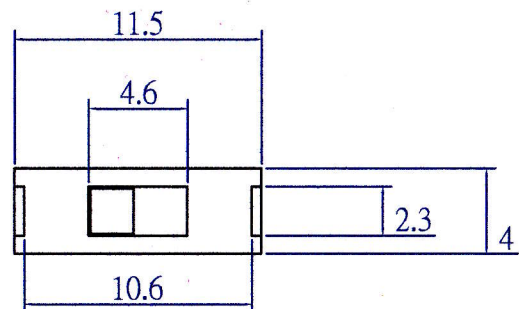

SCHEMATIC

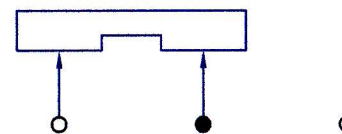

MODEL NO.	L(mm)
G2	2mm
G3	3mm
G4	4mm
G5	5mm
G6	6mm

TRAVEL

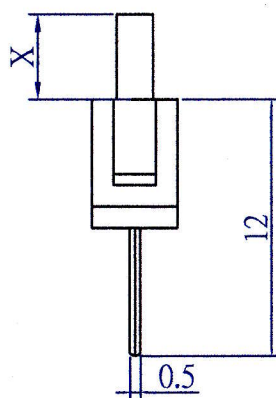
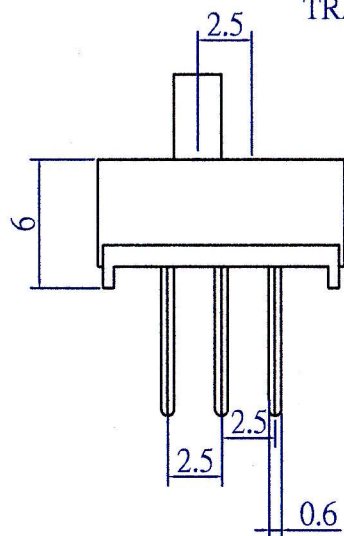

SPECIFICATION

- 1.Circuit : ON-ON(1P2T)
- 2.Rating : D.C. 50V 0.3A
- 3.Contact R.[max] : D.C. 5V 1A 30mΩ
- 4.Insulation R.[min] : D.C. 500V 100MΩ
- 5.Withstand VOL. : A.C. 500V 1minute
- 6.Operating force : 300±100g
- 7.Life cycle[max] : 10,000 cycles

D

D

	單位 mm	比例 5 : 1	日期 06-12-2001	核准	審核	設計繪圖	料號 BSL-SS12E01-G()	頁數 1 / 1
	科奕科技有限公司						品名 SLIDE SWITCH	
						圖號 BSL-SS12E01-G()	版本 A	

1

2

3

4

5